

MODULAR Backyard HOMES



Artist conceptual rendering with after-market craftsman front porch. We can match your architectural styles, call for quote.

IRC Site Ready Features*

- 12" Engineered Truss Joist Floors
- APA Rated Tongue & Groove Subflooring
- Insulated Perimeter Heat Duct System
- Forced-Air Downflow Furnace AC Ready
- 67 Gallon 1st Hour Rating Water Heater
- In-Floor Pex Fresh Water Plumbing
- 8' Sidewalls Flat Ceiling
- 4/12 Pitched Roof With Vented Ridge
- 12" Eaves & Vented Overhangs all Around
- Vinyl Frame Low-E w/Argon Windows
- Insulated Steel Doors With Deadbolts
- China Bathroom Sinks & Elongated Stools
- 3-Hinge Hung Interior Passage Doors

Plans To Fit Any Budget or Project

Sales Centers

Future Homes Bremerton/Gorst 360-479-4663

Superior Homes Fife/Tacoma 253-926-0455

*Meets WA state code for modular homes, 2010 energy code, seismic category D1. Does not include freight, foundation, set-up, carpet installation or utility connections.

BACKYARD MODULAR (1080 Sq. Ft.)

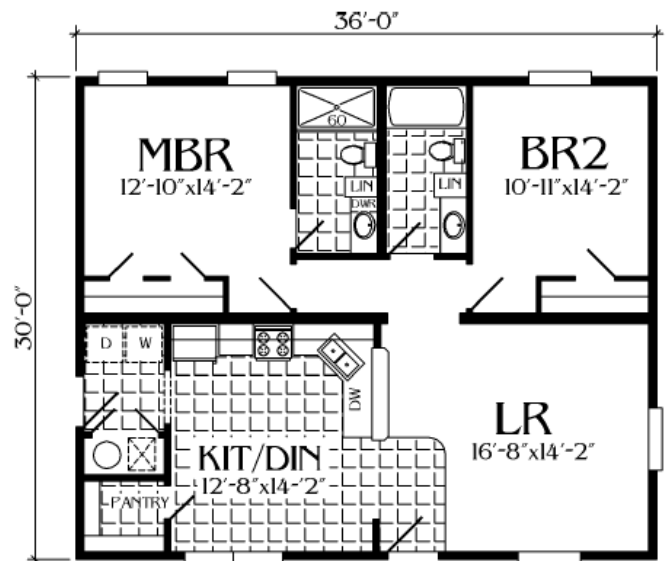

2BR, 2BA 324002
MOD SERIES MODEL M4R36-G02
The Cascadia

CALL TODAY AND DISCOVER
THE MODULAR ADVANTAGE

